

Operation Manual Wireless Adapter

Applicable models (as of April 2018)	LCD MONITOR PN-B401/PN-B501/PN-M401/PN-M501
---	--

Available models differ according to region.

CAN ICES-3 (A) / NMB-3 (A)

● Thank you for purchasing a SHARP product.

Before using the product, please be sure to read this operation manual carefully. Before using the product, be sure to read and understand the "SAFETY PRECAUTIONS" in the operation manual of the LCD MONITOR. After reading the manual, keep it in a convenient location where it can be accessed at any time. As for how to use the product, refer to the manual of the LCD MONITOR.

TIPS

- This product was shipped after strict quality control and inspection; however, if breakage or a malfunction should be found, contact your SHARP dealer or your nearest customer contact.
- Please understand that SHARP CORPORATION bears no responsibility for errors made during use by the customer or a third party, nor for any other malfunctions or damage to this product arising during use, except where indemnity liability is recognized under law.
- This product and its accessories may be upgraded without advance notice.

IMPORTANT:

To aid reporting in case of loss or theft, please record the product's model and serial numbers in the space provided. The numbers are located in the rear of the product.

Model No.:

Serial No.:

U.S.A. ONLY

WARNING:

FCC Regulations state that any unauthorized changes or modifications to this equipment not expressly approved by the manufacturer could void the user's authority to operate this equipment.

NOTE:

This equipment has been tested and found to comply with the limits for Class A digital device, pursuant to Part 15 of the FCC Rules. These limits are designed to provide reasonable protection against harmful interference when the equipment is operated in a commercial environment. This equipment generates, uses, and can radiate radio frequency energy and, if not installed and used in accordance with the instruction manual, may cause harmful interference to radio communications. Operation of this equipment in a residential area is likely to cause harmful interference in which case the user will be required to correct the interference at his own expense.

FCC CAUTION

Changes or modifications not expressly approved by the party responsible for compliance could void the user's authority to operate the equipment.

This transmitter must not be co-located or operated in conjunction with any other antenna or transmitter.

U.S.A. ONLY

This device complies with Part 15 of FCC Rules and Industry Canada licence-exempt RSS standard(s). Operation is subject to the following two conditions: (1) this device may not cause interference, and (2) this device must accept any interference, including interference that may cause undesired operation of this device.

This equipment complies with FCC/IC radiation exposure limits set forth for an uncontrolled environment and meets the FCC radio frequency (RF) Exposure Guidelines and RSS-102 of the IC radio frequency (RF) Exposure rules. This equipment has very low levels of RF energy that are deemed to comply without testing of specific absorption ratio (SAR).

U.S.A. AND
CANADA ONLY

WARNING:

This is a class A product. In a domestic environment this product may cause radio interference in which case the user may be required to take adequate counter measures.

To ensure safe and correct use

This operation manual and the product use various displays and labels to ensure safe use. Ignoring these displays and labels and incorrectly using the product could have results as classified below.

Please read the following warning symbol information before reading the rest of this section, and be sure to strictly observe all instructions.



Warning: Not following these instructions could result in death or serious injury.

- **Never try to modify, disassemble, or repair this product.**
Doing so may result in fire, electric shock, or injury.
- **Only use the accessories with specified models.**
Failure to do so may result in fire.

Specifications

Model	PN-ZW01
Wireless communication method	2.4 GHz, IEEE802.11b/g/n 5 GHz, IEEE802.11a/n
Input/output terminals	USB port (2.0 compliant) (Type A)
Dimensions inch (mm)	Approx. 1 (W) x 3 (D) x 7/16 (H) (26.1 x 76.9 x 10.7)
Weight lbs. (g)	Approx. 0.022 (10)

As a part of our policy of continuous improvement, SHARP reserves the right to make design and specification changes for product improvement without prior notice. The performance specification figures indicated are nominal values of production units. There may be some deviations from these values in individual units.

Supplied Components

If any components are missing, please contact your dealer.

- ☐ Wireless adapter: 1



- ☐ Operation manual (this manual)

Installing the Device

1. Insert the device into a USB port on the LCD monitor.

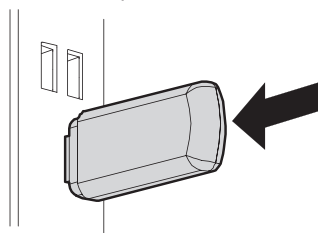

Updating the Firmware

In order to use this product, the LCD monitor's firmware must be updated. Follow the steps below to update the firmware.

■Introduction

On your computer, install the Information Display Downloader from the CD-ROM that is included with the LCD monitor.

- * For information on using the Information Display Downloader, see the operation manual for the Information Display Downloader.

A USB flash drive is required. Ready a USB flash drive that meets the following requirements.

File System	FAT32
Capacity	Up to 32 GB (maximum file size 4 GB)

Do not use a USB flash drive with a security function or write protection function.

■Firmware update procedure

1. Insert the USB flash drive into your computer.
2. Start the Information Display Downloader, and download the firmware to use PN-ZW01 for your model.
3. Update the firmware by following the Update Manual in the downloaded file.

Wireless LAN Settings

When you have finished updating the firmware, follow the steps below to configure the wireless LAN settings on the LCD monitor.

- * For information on using the LCD monitor, see the operation manual for the LCD monitor and the Software Guide.

1. Change the input mode to "APPLICATION" with the input mode selection, or press the CONTENT MENU button.
2. Select "Setup" in the base screen of APPLICATION mode.
3. Set the "Network priority".

If you will use wireless on the LCD monitor, we recommend that you select "Wi-Fi > Ethernet".

4. Select "Wi-Fi (Wireless LAN)" and display the Android™ screen.
5. Enable Wi-Fi in the Android settings, and configure the wireless LAN settings.

■Trademarks

- Android is a trademark of Google LLC.
- Wi-Fi is a registered trademark of Wi-Fi Alliance.